

PIN HEADER 1.27x1.27mm SURFACE MOUNT TYPE

MATERIAL

Insulator : NYLON 6T

Contact Pin : Brass

SPECIFICATION

Current Rate : 1 AMP

Insulation Resistance : 5000MΩ Min. at DC 500V

Contact Resistance : 20mΩ Max. at DC 100mA

Operation Temperature : -55°C to +105°C

ORDER INFORMATION

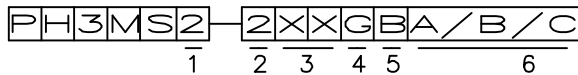

1. 1: Plastic Height=1.0mm
2. 2: Plastic Height=1.5mm
3. 3: Plastic Height=2.5mm
2. 2: Dual rows
3. No. of contacts per row (2~50)
4. G: Gold flash
T: Tin plated
5. B: Black Insulator
6. No standard spec., please fill out A/B/C.

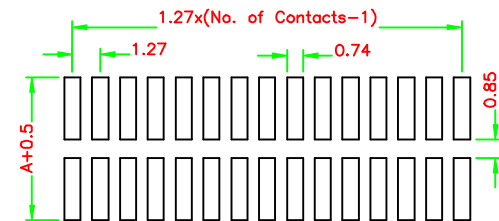
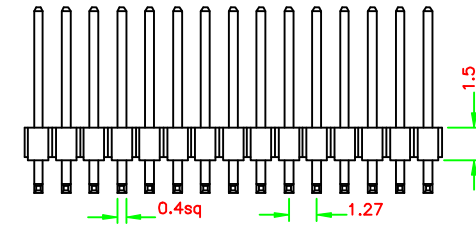
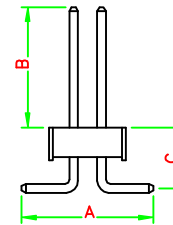
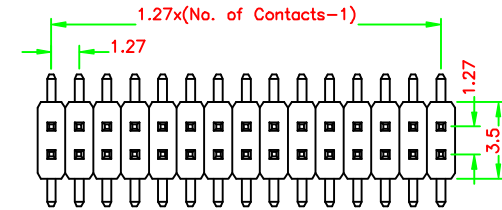

Recommended P.C.B. Layout

UNIT : mm



立河企業有限公司
PINREX ENTERPRISE
CO., LTD

圖名 MOLD NAME	1.27x1.27mm Pin Header SMT type		
圖號 DRAWING NO.	PH3MS2-2XXGB	比例 SCALE	3 : 1
公差 TOLERANCE	±0.2	繪圖 DRAW BY	Carrie
		日期 DATE	011213