

1.27x1.27MM FEMALE HEADER LOW PROFILE 2.15MM SMT TYPE

MATERIAL

INSULATOR : NYLON 6T

CONTACT PIN : Phosphor Bronze

SPECIFICATION

CURRENT RATE : 1 AMP

INSULATION RESISTANCE : 5000MΩ Min.

CONTACT RESISTANCE : 30mΩ Max.

DIELECTRIC VOLTAGE : 500V AC for one minute

OPERATION TEMPERATURE : -55°C to +105°C

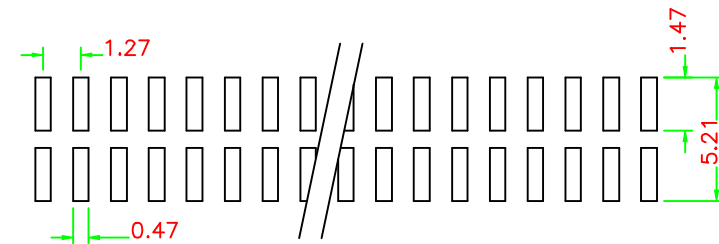
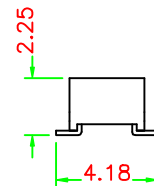
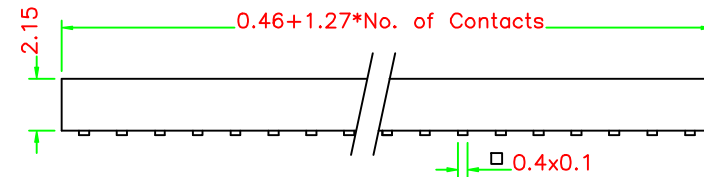
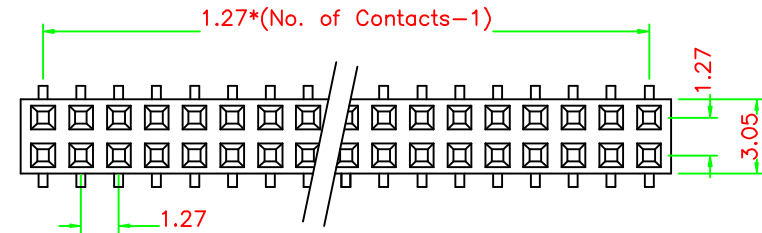

Recommended P.C.B Layout

ORDER INFORMATION

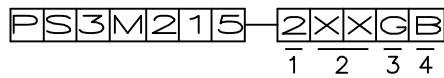

1. 2: Dual rows
2. No. of contacts per row (2~53)
3. G: Gold flash
T: Tin plated
4. B: Black Insulator

UNIT : mm



立河企業有限公司
PINREX ENTERPRISE
CO., LTD

圖名 MOLD NAME	1.27x1.27mm Female Header SMT type		
圖號 DRAWING NO.	PS3M215-2XXGB	比例 SCALE	FREE
公差 TOLERANCE	±0.1	繪圖 DRAW BY	Jarvis
		日期 DATE	890724